

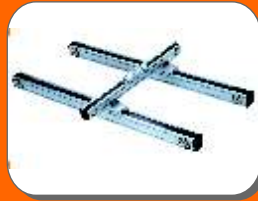

ACTUATORS, X-Y TABLE



LINEAR GUIDEWAY & LM BEARING



BALL SCREW, COUPLING, TIMING BELT & PULLEY



MOTION & CONTROL



ROTARY INDEXING TABLE



ROBOFLEX CHAIN



BEARINGS & BUSHES



AL PROFILE & ACCESSORIES



**LEVELING FOOT MOUNT**

**Distinction**

This wheel master is small body and technical multipurpose wheel used for high press (100kg/4ea~3600kg/4ea). This is made up of the main body gounded by aluminium, the upper plate with a forged. The catapult wheel by specially compounding, synthetic rubber with superior sustproof and dustproof dueice, and the handle designed to simply adjust to high & low.

This wheel master have the advantage of making it easy to remote in a 180 degree are by putting in the ball bearing between upper plate and the main body, also get a change of direction and move easy.

**Function**



(SIMPLE MOVEMENT)



(ADJUSTMENT OF THE HIGH AND LOW AND CUSHION)



(FIXED FUNCTION)

**Applications**

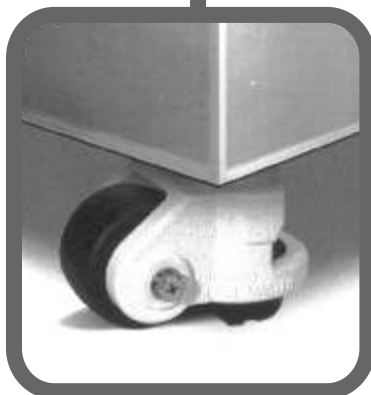
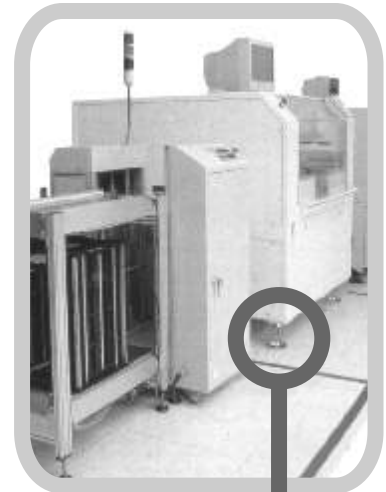
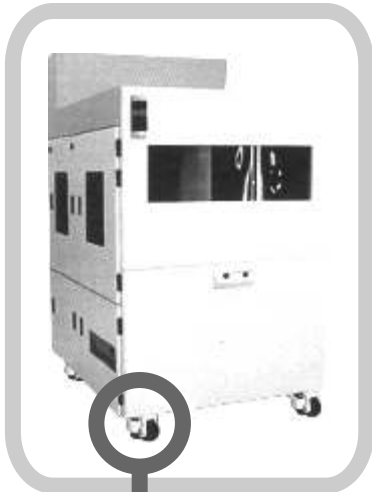

**LEVELING FOOT MOUNT**

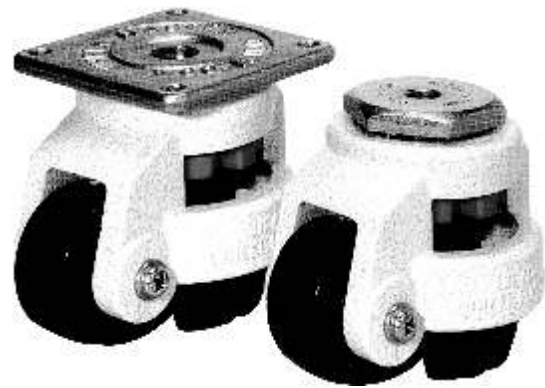

**MATERIAL :**

NO	PARTS	MATERIALS	TREATMENTS
1	TOP PLATE	SM45C	Zn Galvanized
2	BALL	STB2	Ni-Cr
3	FRAME	ADC8	Powder Coated
4	HANDLE	ABS NYLON-6	Red

NO	PARTS	MATERIALS	TREATMENTS
5	Leveller (MB)	SM45C	Zn Galvanized
6	FOOT	N.B.R.	Black
7	PIN	SM45C	Zn Galvanized
8	WHEEL	ABS NYLON-6	Black

**(Dimensions)**

(Unit : mm)

**WI-40F**

# WI-40

(LIGHT DUTY PURPOSE)

**SPECIFICATION :**

- (Load/Unit) : 50 kg/EA
- (Recommended) : 100kg/4EA
- (Net Weight) : F-TYPE-0.38 kg / S-TYPE-0.38 kg
- (Temperature range) : -10~+90°C

**(Dimensions)**

(Unit : mm)

**WI-60F**

# WI-60

(LIGHT DUTY PURPOSE)

**SPECIFICATION :**

- (Load/unit) : 300 kg/EA
- (Recommend) : 600kg/4EA
- (Net Weight) : F-TYPE-0.77 kg / S-TYPE-0.63 kg
- (Temperature range) : -10~+90°C

**LEVELING FOOT MOUNT**



**MATERIAL :**

NO	PARTS	MATERIALS	TREATMENTS
1	TOP PLATE	SM45C	Zn Galvanized
2	BALL	STB2	Ni-Cr
3	FRAME	ADC8	Powder Coated
4	HANDLE	ABS NYLON-6	Red

NO	PARTS	MATERIALS	TREATMENTS
5	Leveller (M8)	SM45C	Zn Galvanized
6	FOOT	N.B.R.	Black
7	PIN	SM45C	Zn Galvanized
8	WHEEL	ABS NYLON-6	Black

(Dimensions)

(Unit : mm)

**WI-80F**

## WI-80

(MEDIUM DUTY PURPOSE)

**SPECIFICATION :**

- (Load/Unit) : 600 kg/EA
- (Recommended) : 1,200kg/4EA
- (Net Weight) : F – TYPE – 1.40 kg / S – TYPE – 1.19 kg
- (Temperature range) : -10~+90°C

(Dimensions)

(Unit : mm)

**WI-100F**

## WI-100

(LIGHT DUTY PURPOSE)

**SPECIFICATION :**

- (Load/Unit) : 1,000 kg/EA
- (Recommended) : 2,000kg/4EA
- (Net Weight) : F–TYPE–1.84 kg / S–TYPE–1.56 kg
- (Temperature range) : -10~+90°C

**LEVELING FOOT MOUNT**

# WI-120

(MEDIUM DUTY PURPOSE)



(Dimensions)

(Unit : mm)

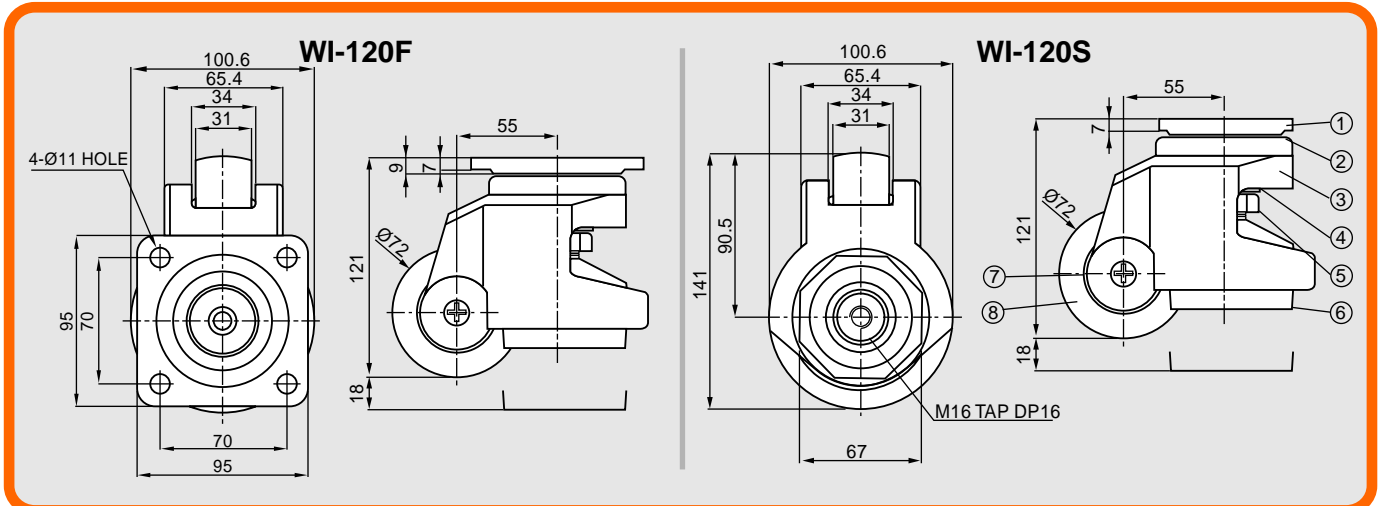

## SPECIFICATION :

- (Load/Unit) : 1,300 kg/EA
- (Recommended) : 2,600kg/4EA
- (Net Weight) : F-TYPE-1.95 kg / S-TYPE-1.69 kg
- (Temperature range) : -10~+90°C

## MATERIAL :

NO	PARTS	MATERIALS	TREATMENTS
1	TOP PLATE	SM45C	Zn Galvanized
2	BALL	STB2	Ni-Cr
3	FRAME	ADC8	Powder Coated
4	NUT	SM45C	Zn Galvanized

NO	PARTS	MATERIALS	TREATMENTS
5	Leveller (MB)	SUS304	
6	FOOT	ADC8	Black
7	PIN	SM45C	Zn Galvanized
8	WHEEL	ABS NYLON-6	Black

Regd. Office : 5224, Nigam Market, G.B. Road, Delhi - 110006

Head Office : B-97/4, Naraina Industrial Area, Phase - I, New Delhi - 28 Ph.: 011 - 42709155 / 66 Fax : 011 - 45040209

Branch Office : Door No. 1/9, Rajamannar Salai, Vijayaraghavapuram, K.K. Nagar, Chennai - 600 093 Ph.: 044 - 42669808

Email : [info@pbh.in](mailto:info@pbh.in)

H-51

Website : [www.pbh.in](http://www.pbh.in)

LEVELING FOOT MOUNT

# WI-150

(ULTRA HEAVY DUTY PURPOSE)

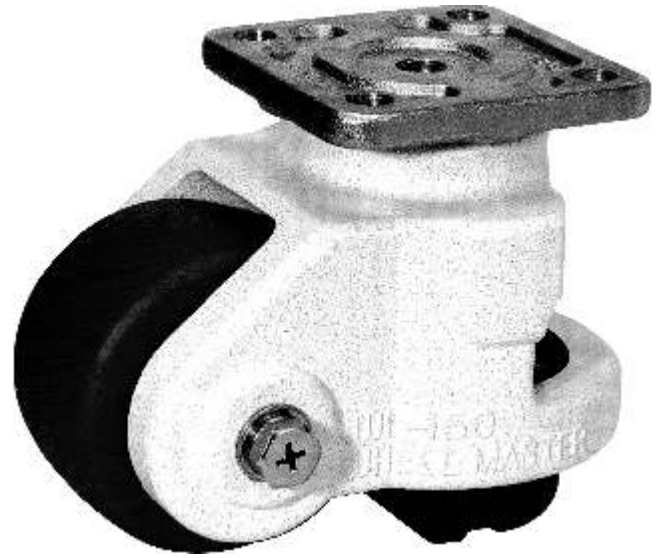

(Dimensions)

(Unit : mm)

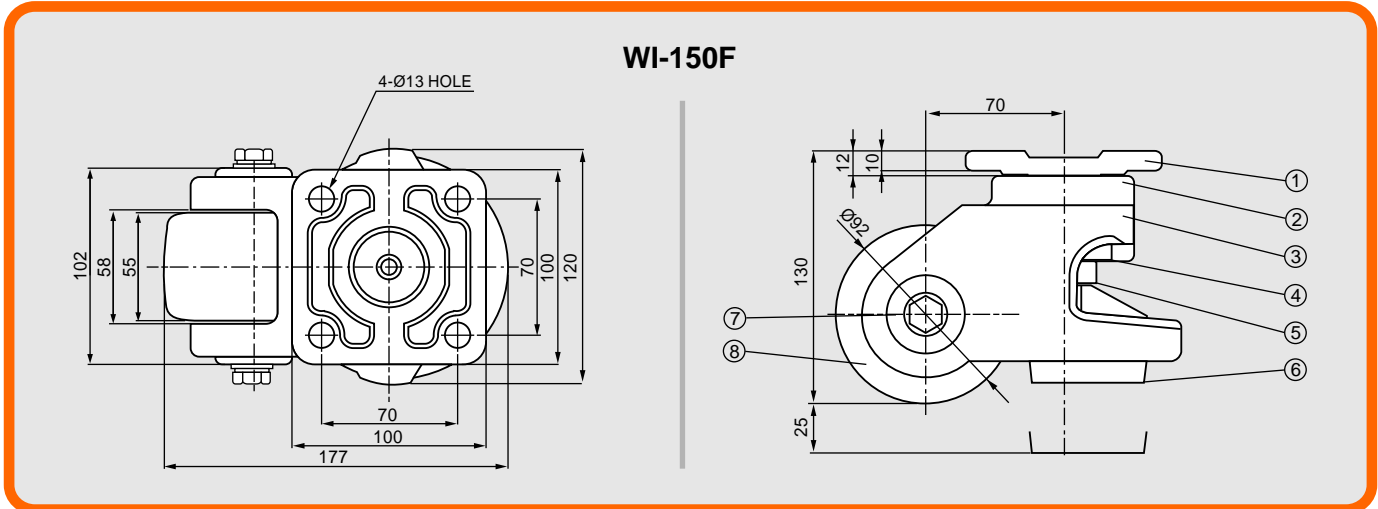

## SPECIFICATION :

- (Load/Unit) : 1,800 kg/EA
- (Recommended) : 3,600kg/4EA
- (Net Weight) : F-TYPE-3.37 KG
- (Temperature range) : -10~+90°C

## MATERIAL :

NO	PARTS	MATERIALS	TREATMENTS
1	TOP PLATE	SM45C	Zn Galvanized
2	BALL	STB2	Ni-Cr
3	FRAME	ADC8	Powder Coated
4	NUT	SM45C	Zn Galvanized

NO	PARTS	MATERIALS	TREATMENTS
5	Leveller (M16)	SUS304	
6	FOOT	ADC8	Black
7	PIN	SM45C	Zn Galvanized
8	WHEEL	MC NYLON	Sky Blue

Regd. Office : 5224, Nigam Market, G.B. Road, Delhi - 110006

Head Office : B-97/4, Naraina Industrial Area, Phase - I, New Delhi - 28 Ph.: 011 - 42709155 / 66 Fax : 011 - 45040209

Branch Office : Door No. 1/9, Rajamannar Salai, Vijayaraghavapuram, K.K. Nagar, Chennai - 600 093 Ph.: 044 - 42669808

Email : info@pbh.in

H-52

Website : www.pbh.in

# WIM-600, WIMT-600

(MEDIUM DUTY PURPOSE)

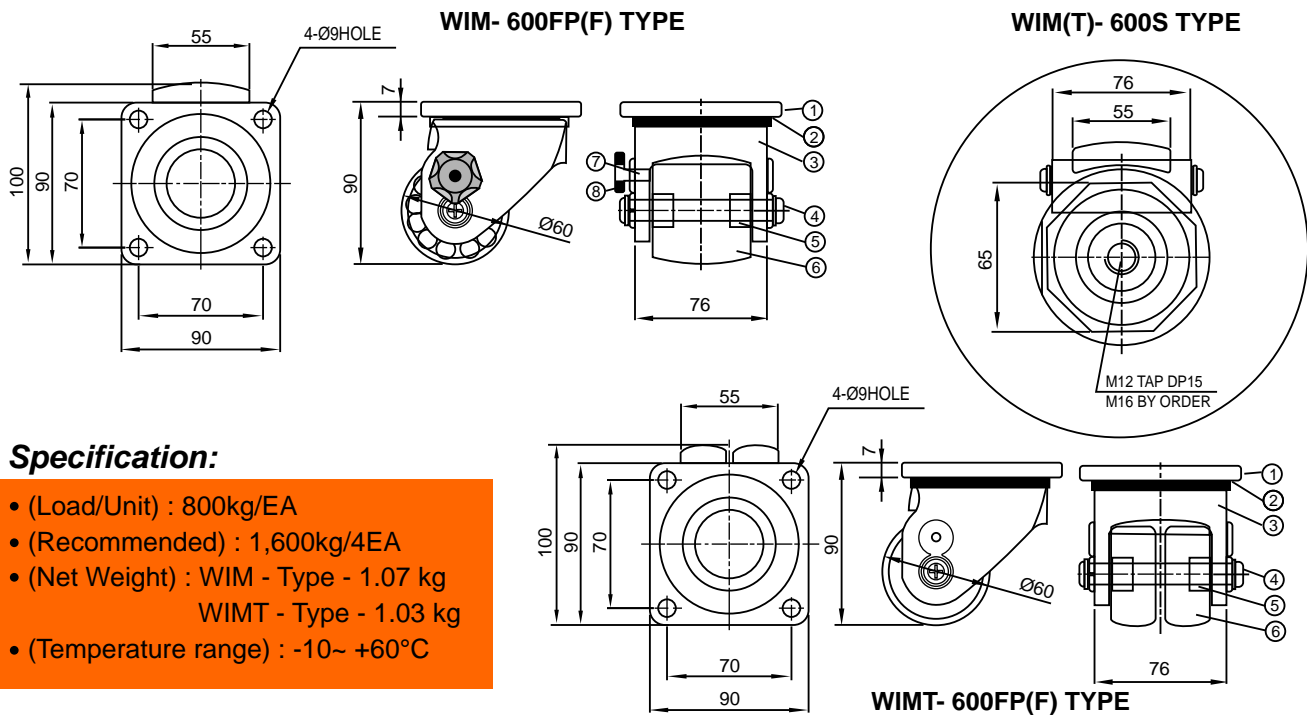

**Specification:**

- (Load/Unit) : 800kg/EA
- (Recommended) : 1,600kg/4EA
- (Net Weight) : WIM - Type - 1.07 kg  
WIMT - Type - 1.03 kg
- (Temperature range) : -10~ +60°C

**MATERIAL :**

NO	PARTS	MATERIALS	TREATMENTS
1	TOP PLATE	SM45C	Zn Galvanized (3+)
2	BALL	STB2	Ni-Cr
3	FRAME	ADC8	Powder Coated
4	PIN	SM45C	Zn Galvanized
5	BEARING	HK1212	
6	WHEEL	NYLON-6	Black
7	BRAKE BOLT	SM45C	Zn Galvanized (3+)
8	HANDLE	ABS	Black

# WIM-800, WIMT-800

(MEDIUM DUTY PURPOSE)



**WIM- 800FP(F) TYPE**

**WIM(T)- 800S TYPE**

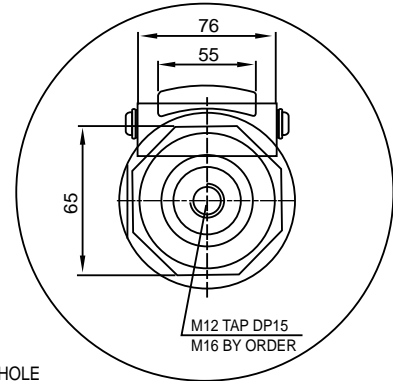
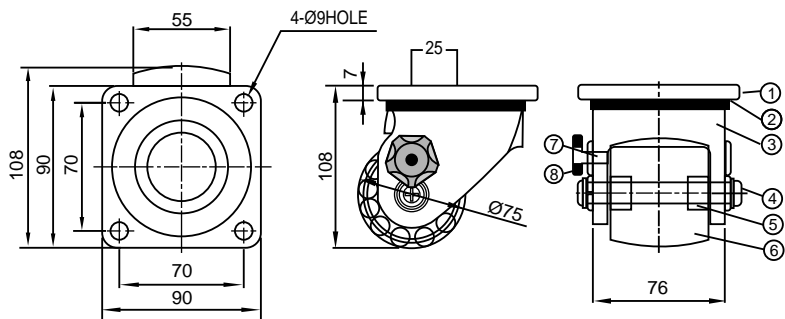

**Specification:**

- (Load/Unit) : 1,000kg/EA
- (Recommended) : 2,000kg/4EA
- (Net Weight) : WIM - Type - 1.27 kg  
WIMT - Type - 1.13 kg
- (Temperature range) : -10~ +60°C

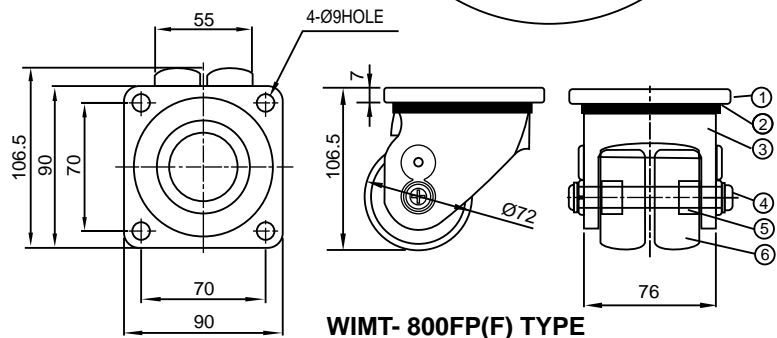

**WIMT- 800FP(F) TYPE**

**MATERIAL :**

NO	PARTS	MATERIALS	TREATMENTS
1	TOP PLATE	SM45C	Zn Galvanized (3+)
2	BALL	STB2	Ni-Cr
3	FRAME	ADC8	Powder Coated
4	PIN	SM45C	Zn Galvanized
5	BEARING	6301Z	
6	WHEEL	NYLON-6	Black
7	BRAKE BOLT	SM45C	Zn Galvanized (3+)
8	HANDLE	ABS	Black

**WLC-200,**  
(LIGHT DUTY PURPOSE)

**WLC-700**  
(MEDIUM DUTY PURPOSE)



**WLC-200FP**

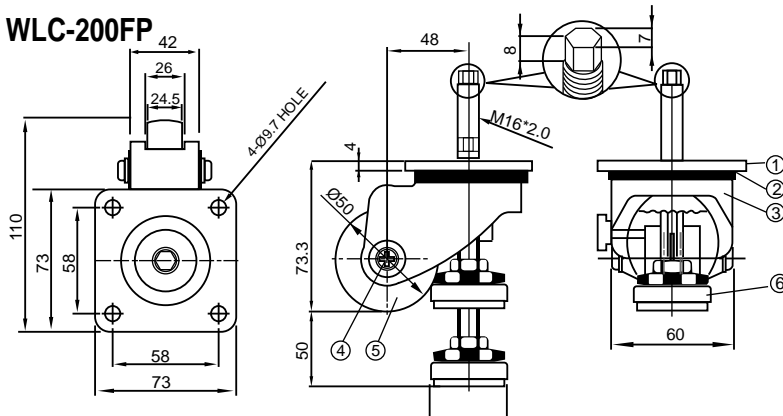

**Specification:**

**WLC-200FP**

- (Load/Unit) : 200kg/EA
- (Recommended) : 400kg/4EA
- (Net Weight) : WLC-200FP-0.69kg
- (Temperature range) : -10 ~ +60°C

**WLC-700FP**

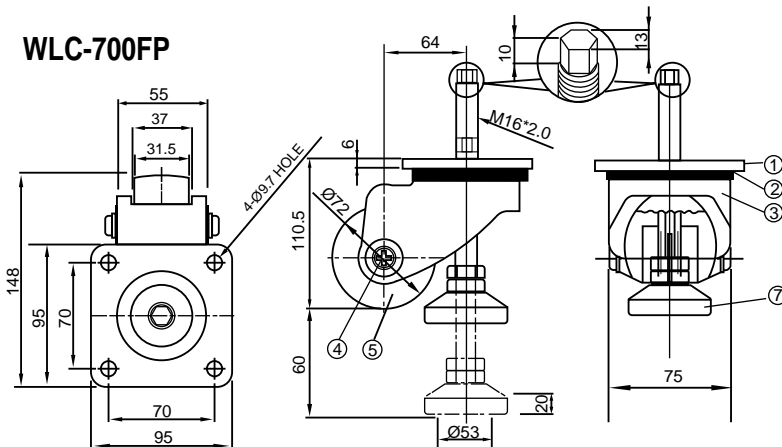

**WLC-700FP**

- (Load/Unit) : 700kg/EA
- (Recommended) : 1,400kg/4EA
- (Net Weight) : WLC-700FP-1.65kg
- (Temperature range) : -10 ~ +60°C

**MATERIAL :**

NO	PARTS	MATERIALS	TREATMENTS
1	TOP PLATE	SM45C	Zn Galvanized (3+)
2	BALL	STB2	Ni-Cr
3	FRAME	ADC8	Powder Coated
4	PIN	SM45C	Zn Galvanized
5	WHEEL	NYLON-6	Black
6	FOOT	WLC-200FP: SM45C, SPC, NBR WLC-700FP: SM45C	Ni

## SOLUTIONS FOR INDUSTRIAL AUTOMATION

- Linear Guides
- Ball Screw & Lead Screw
- Ball Screw Support Unit
- Coupling
- Linear Motion Bearing
- Shafts (Hardened & Ground)
- Pillow Block Bearing Unit
- Precision Lock Nut & Power Lock
- Timing Belt & Pulley
- Actuators, X-Y Tables
- Maxima Work Table & Conveyor
- Stepper Motors, Drivers
- AC Servo Motors & Drive
- Motion & Controllers
- Rotary Indexing Tables
- Cable Drag Chain (Robochain)
- Aluminium Profile & Accessories
- Leveling Foot Mount & Autocaster



Maxima Conveyor



Maxima Work Table