

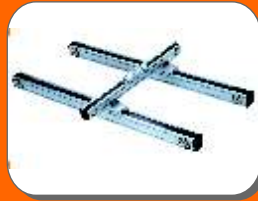

ACTUATORS, X-Y TABLE



LINEAR GUIDEWAY & LM BEARING



BALL SCREW, COUPLING, TIMING BELT & PULLEY



MOTION & CONTROL



ROTARY INDEXING TABLE



ROBOFLEX CHAIN



BEARINGS & BUSHES



AL PROFILE & ACCESSORIES



MAXIMA ACTUATOR

Linear Actuator based Customized Solutions

Based on our linear actuators we can provide :

- X slide X-Y slide X-Y-Z slides
- Gantry Shaped slides
- Choice of stepper / servo motors
- Drives for stepper / servo motors
- Programmable motion controllers (no need for PLC)
- Solutions include components like couplings, sensors, Motor mounting block, Cable drag chain, SMPS power supply
- Aluminum / MS frame of the machine

Applications

- Pick and Place
- Engraving applications
- Teach & Play(robotic)
- Welding applications
- Liquid Dispensing
- Material Handling



Max 90



Max 170



Max 124

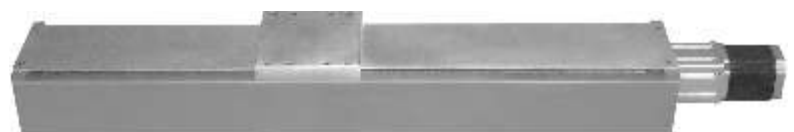

Max 180



Max SERO



Max SERO - S



Max 124 Manual Type



Max Rod Electric Cylinder

MAXIMA ACTUATOR

ULTRA LINEAR ACTUATOR (LINEAR SLIDES)



Maxima Motion & Controls Pvt Ltd brings to you Ball screw or Belt Drive based linear actuators.

Now instead of buying linear slides, ball screw coupling separately you can buy linear actuators which are ready to use.

FAQ'S

What is out ?

The hassle of grinding the base plate checking the parallelism of linear guides, checking alignment of ball screw is gone.

What is in ?

Ready to use linear actuator. Plug & Play

What does the actuator come with ?

Actuator comes with mounting plate ready to take the load. It comes with sensor rail & motor mounting block. Couplings are optional

How do I select an actuator ?

If you are not able to select from the catalogue, please provide us the following details:

- Stroke Required
- Payload in Kgf
- Cantilever distance from the center of the actuator (if any)
- Max Speed of operation
- Motor type stepper/servo
- Brief description of your application

What is the difference between ball screw based & belt drive based actuator ?

Thumb rule says that ball screw actuators are for precision / high load capacity applications ; belt driven actuators are for high speed / very high speed / long stroke / light duty applications.

What if I want complete solution ?

We specialize providing complete solutions. As per your requirement we can provide you linear actuator with stepper or servo motors with driver & programmable motion controller, smps power supply

What is your range of servo / stepper motors ?

Please refer to our Motion& Control section for more detail on servo and stepper motors

If I use programmable motion controller do i still have to use a PLC ?

No PLC is required if using Programmable motion controller. We can provide 1-Axis, 2-Axis and 4-Axis Motion Controllers

MAXIMA ACTUATOR

MAX 90 C



Features

- Metal Cover for dust protection
- Light Weight
- Base plate is aluminium with slots so that actuator can be mounted with nut at any distance
- Motor Mounting Blocks are customizable

Optional items :

- Stepper motor with driver
- Servo Motor with driver
- Controller
- SMPS Power Supply
- Sensor

Applications :

- Automation
- Pick and Place
- Engraving
- Liquid Dispensing
- Material Handling

MAX 90 CH Actuator includes:

- Linear Guides of 12 mm (4 Carriage + 2 rails)
- Ball Screw of 12 mm Dia with pitch option of 5 mm
- Standard Ball Screw Support Units
- Oldham coupling OD 25 mm
- Motor Mounting Block (option of frame size 57,60)

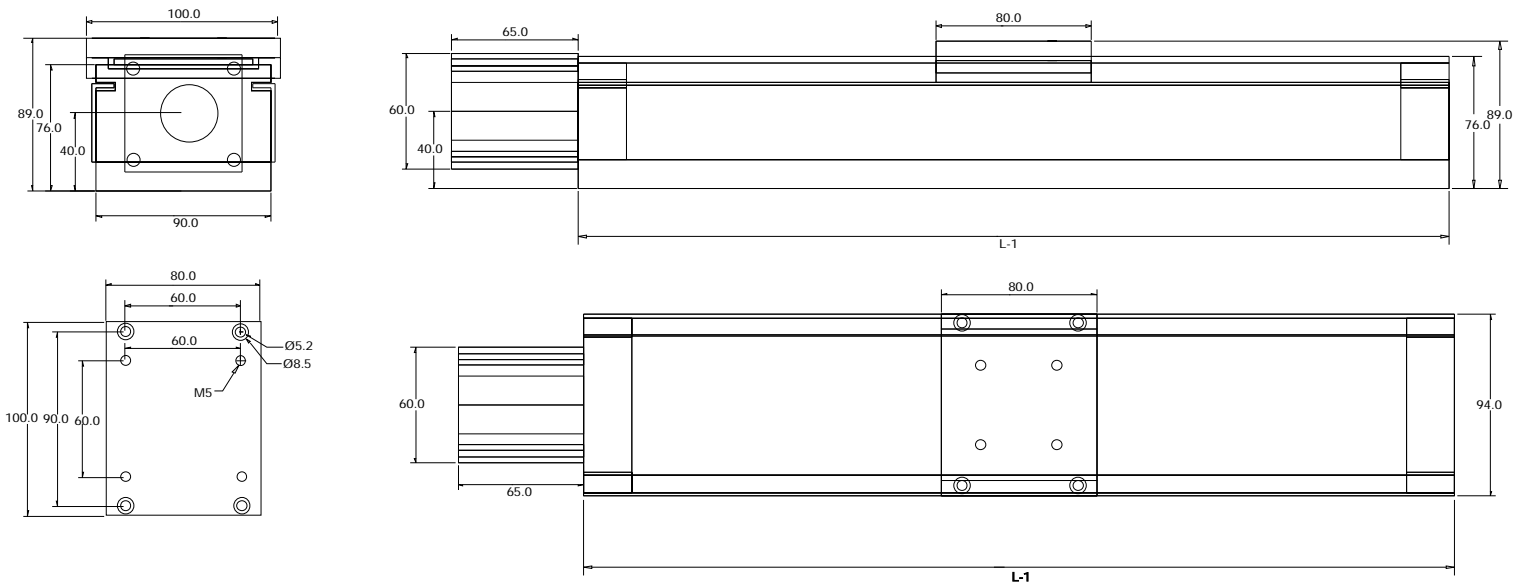

How to Order

MAX 90 C H A- (Stroke) MM

Stroke in MM	L1 in MM
50 mm	200 mm
100 mm	250 mm
150 mm	300 mm
200 mm	350 mm
250 mm	400 mm

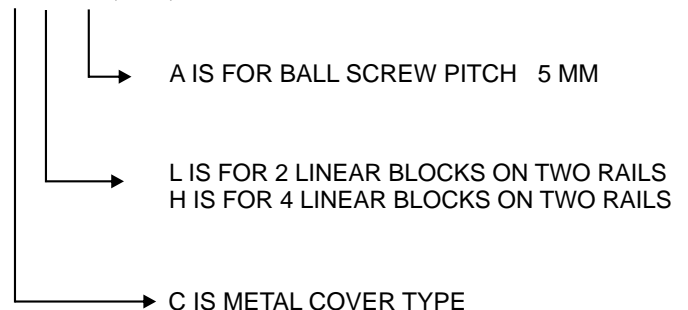

MAXIMA ACTUATOR

MAX 124 C



Features

- Metal Cover for Dust protection
- Light Weight
- Base plate is aluminium with slots so that actuator can be mounted with t nut at any distance
- Motor Mounting Blocks are customizable

Applications :

- Automation
- Pick and Place
- Engraving
- Liquid Dispensing
- Material Handling

MAX 124 CH Actuator includes:

- Linear Guides of 15 mm (2 Carriage + 2 rails)
- Ball Screw of 16 mm Dia with pitch option of 5 mm 10 mm 16 mm
- Standard Ball Screw Support Units
- Oldham coupling OD 32 mm
- Motor Mounting Block (option of frame size 57,60,86)

Optional items :

- Stepper motor with driver
- Servo Motor with driver
- Controller
- SMPS Power Supply
- Sensor

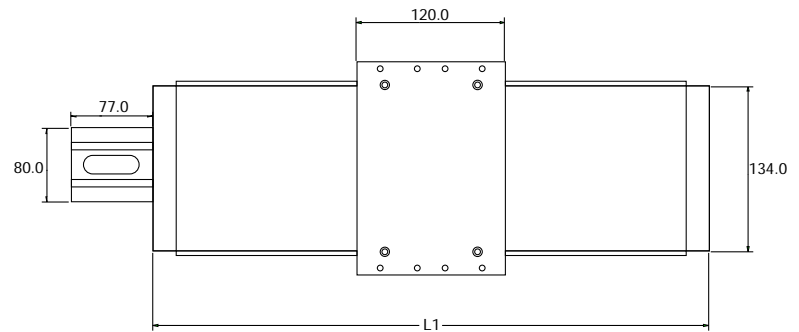
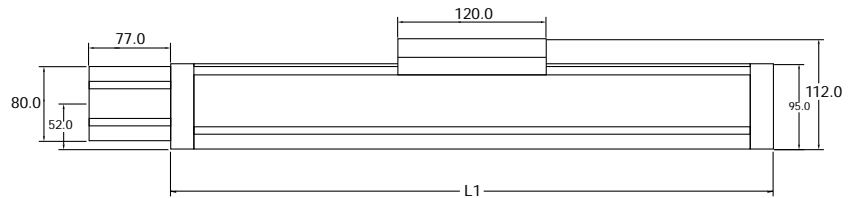
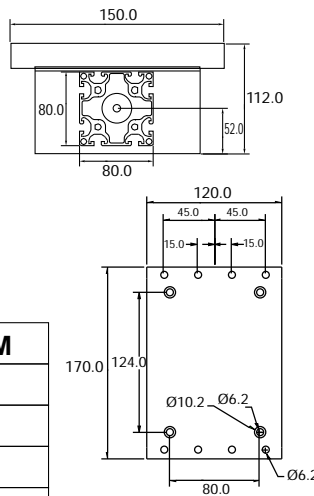

Stroke in MM	L1 in MM
100 mm	270 mm
200 mm	370 mm
300 mm	470 mm
400 mm	570 mm
500 mm	670 mm
600 mm	770 mm
700 mm	870 mm
800 mm	970 mm
900 mm	1070 mm
1000 mm	1170 mm
1100 mm	1270 mm
1200 mm	1370 mm
1300 mm	1470 mm
1400 mm	1570 mm
1500 mm	1670 mm

M2= 75 mm or 77 mm or user defined

How to Order

MAX 124 C H A- (Stroke) MM

A IS FOR BALL SCREW PITCH 5 MM
B IS FOR BALL SCREW PITCH 10 MM
C IS FOR BALL SCREW PITCH 16 MM

L IS FOR 2 LINEAR BLOCKS ON TWO RAILS
H IS FOR 4 LINEAR BLOCKS ON TWO RAILS

C IS METAL COVER TYPE

MAXIMA ACTUATOR

MAX 170 C



Features

- Metal Cover for dust protection
- Light Weight
- Base plate is aluminium with slots so that actuator can be mounted with nut at any distance
- Motor Mounting Blocks are customizable

Optional items :

- Stepper motor with driver
- Servo Motor with driver
- Controller
- SMPS Power Supply
- Sensor

Applications :

- Automation
- Pick and Place
- Engraving
- Liquid Dispensing
- Material Handling

MAX 170 CH Actuator includes:

- Linear Guides of 20 mm (4 Carriage + 2 rails)
- Ball Screw of 20 mm Dia with pitch option of 5 mm or 20 mm
- Standard Ball Screw Support Units
- Oldham coupling OD 32 mm
- Motor Mounting Block (option of frame size 57,60,86)

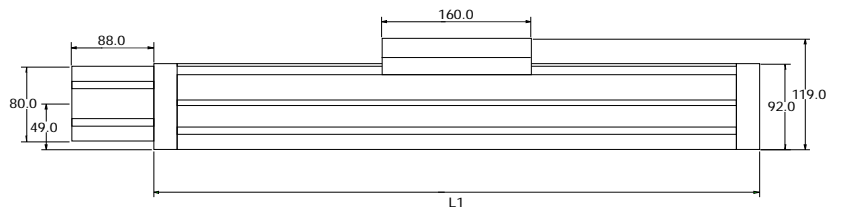
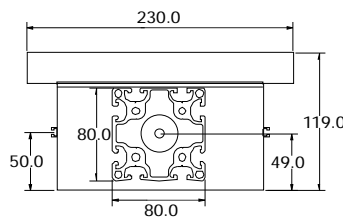

Stroke in MM	L1 in MM
200 mm	430 mm
300 mm	530 mm
400 mm	630 mm
500 mm	730 mm
600 mm	830 mm
700 mm	930 mm
800 mm	1030 mm
900 mm	1130 mm
1000 mm	1230 mm
1100 mm	1330 mm
1200 mm	1430 mm
1300 mm	1530 mm
1400 mm	1630 mm
1500 mm	1730 mm
1600 mm	1830 mm
1700 mm	1930 mm
1800 mm	2030 mm
1900 mm	2130 mm
2000 mm	2230 mm

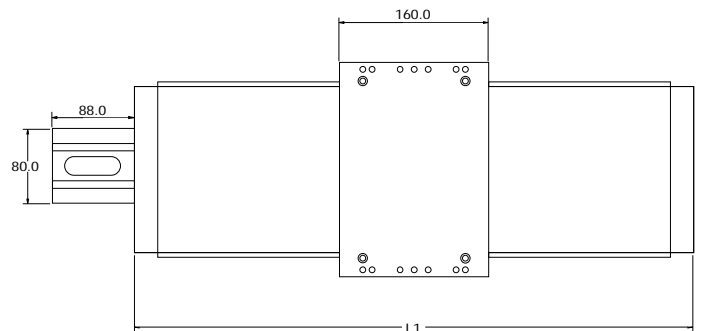
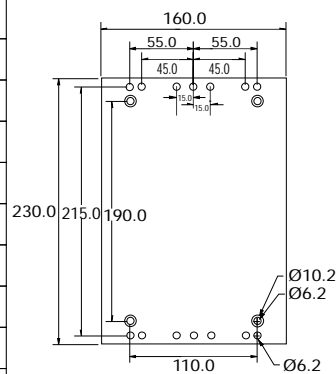

How to Order

MAX 170 C H A- (Stroke) MM

- A IS FOR BALL SCREW PITCH 5 MM
C IS FOR BALL SCREW PITCH 20 MM
- L IS FOR 2 LINEAR BLOCKS ON TWO RAILS
H IS FOR 4 LINEAR BLOCKS ON TWO RAILS
- C IS METAL COVER TYPE

MAXIMA ACTUATOR

MAX HS 170 C (High Speed)



Features

- High Speed
- Low Noise
- Metal Cover for dust protection
- Light Weight
- Base plate is aluminum with slots so that actuator can be mounted with nut at any distance
- Motor Mounting Blocks are customizable

- Optional items :**
- Stepper motor with driver
 - Servo Motor with driver
 - Controller
 - SMPS Power Supply
 - Sensor

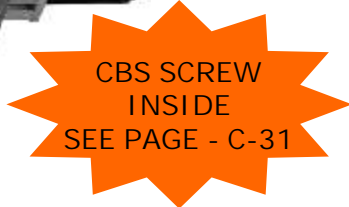

MAX HS 170 CH High Speed Actuator includes :

- Linear Guides of 20 mm (4 Carriage + 2 rails)
- Ball Screw of 20 mm Dia with pitch option of 10 mm, 20 mm or 30 mm
- Standard Ball Screw Support Units
- Oldham coupling OD 32 mm
- Motor Mounting Block (option of frame size 57,60,86)

Applications :

- Automation
- Pick and Place
- Engraving
- Liquid Dispensing
- Material Handling

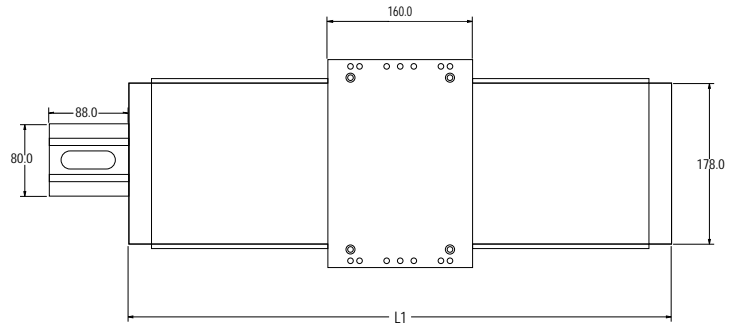
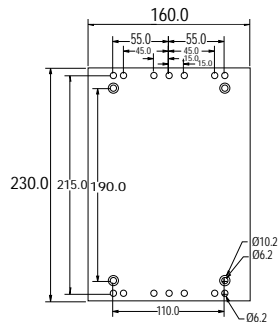
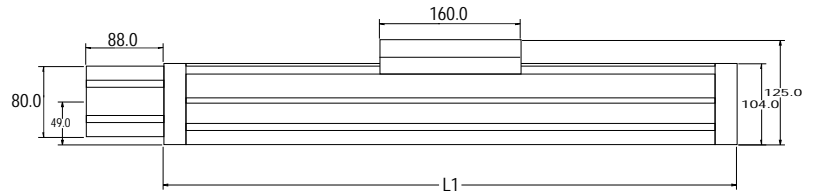
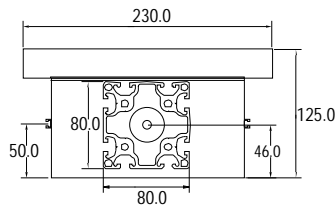

Stroke in MM	L1 in MM
200 mm	430 mm
300 mm	530 mm
400 mm	630 mm
500 mm	730 mm
600 mm	830 mm
700 mm	930 mm
800 mm	1030 mm
900 mm	1130 mm
1000 mm	1230 mm
1100 mm	1330 mm
1200 mm	1430 mm
1300 mm	1530 mm
1400 mm	1630 mm
1500 mm	1730 mm
1600 mm	1830 mm
1700 mm	1930 mm
1800 mm	2030 mm
1900 mm	2130 mm
2000 mm	2230 mm

How to Order

MAX HS 170 C H A - (Stroke) MM

- A IS FOR BALL SCREW PITCH 10 MM
- B IS FOR BALL SCREW PITCH 20 MM
- C IS FOR BALL SCREW PITCH 30 MM

- L IS FOR 2 LINEAR BLOCKS ON TWO RAILS
- H IS FOR 4 LINEAR BLOCKS ON TWO RAILS

- C IS METAL COVER TYPE

MAX 180 B

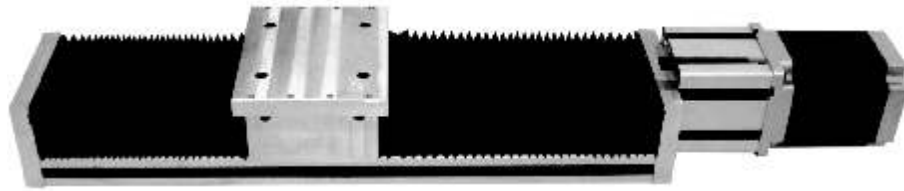

Features

- Bellow for Dust protection
- Light Weight
- Base plate is aluminium with slots so that actuator can be mounted with nut at any distance
- Motor Mounting Blocks are customizable

- Optional items :**
- Stepper motor with driver
 - Servo Motor with driver
 - Controller
 - SMPS Power Supply
 - Sensor

MAX 180 BH Actuator includes:

- Linear Guides of 20 mm (4 Carriage + 2 rails)
- Ball Screw of 20 mm Dia with pitch option of 5 mm or 20 mm
- Standard Ball Screw Support Units
- Oldham coupling OD 32 mm
- Motor Mounting Block (option of frame size 57,60,86)

Stroke in MM
200 mm
300 mm
400 mm
500 mm
600 mm
700 mm
800 mm
900 mm
1000 mm
1200 mm
1500 mm

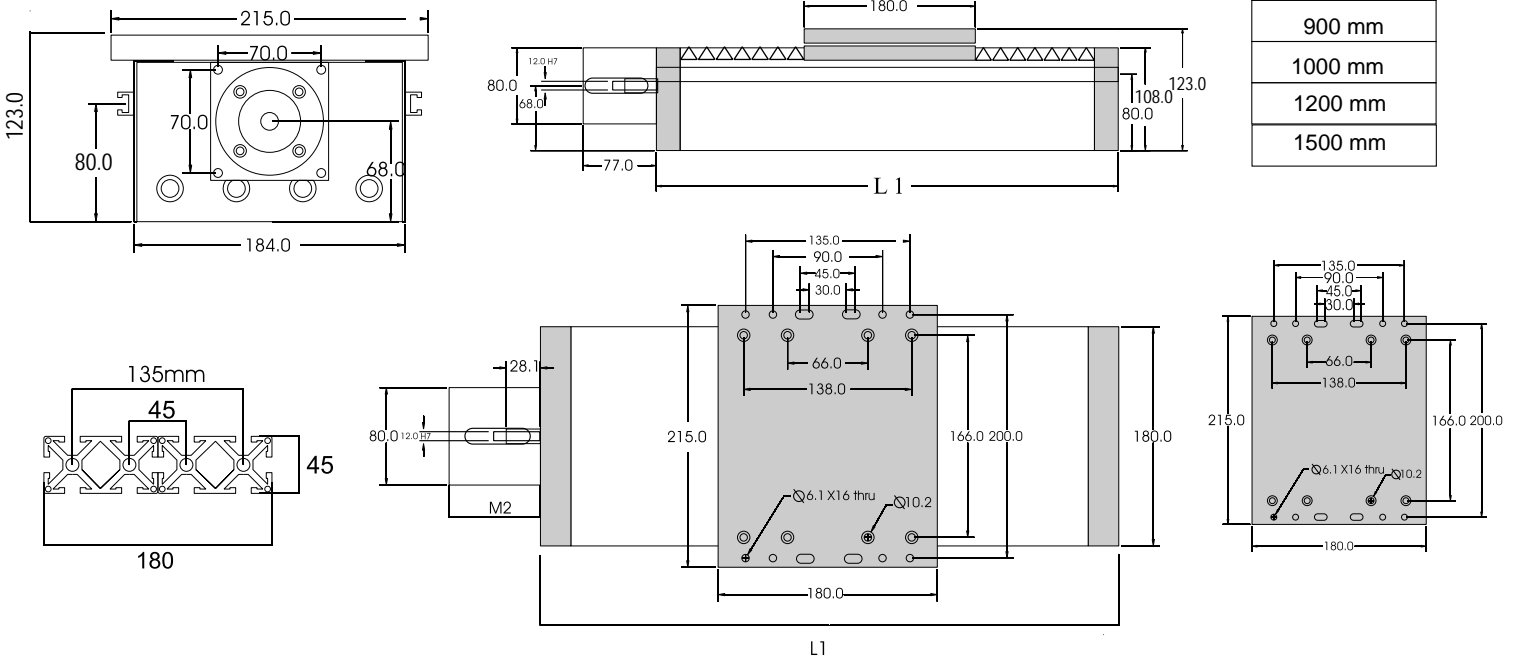

How to Order

MAX 180 B H A- (Stroke) MM

Applications :

- Automation
- Pick and Place
- Engraving
- Liquid Dispensing
- Material Handling

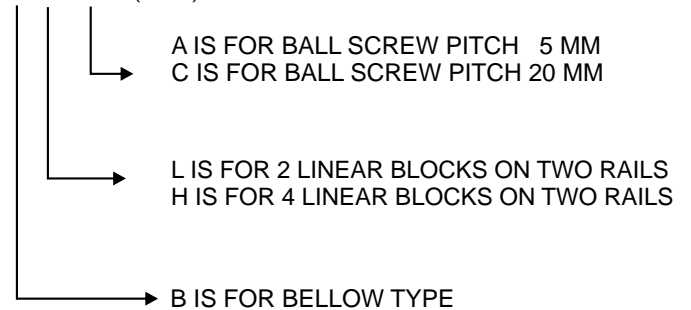

MAXIMA ACTUATOR

MAX 180 C

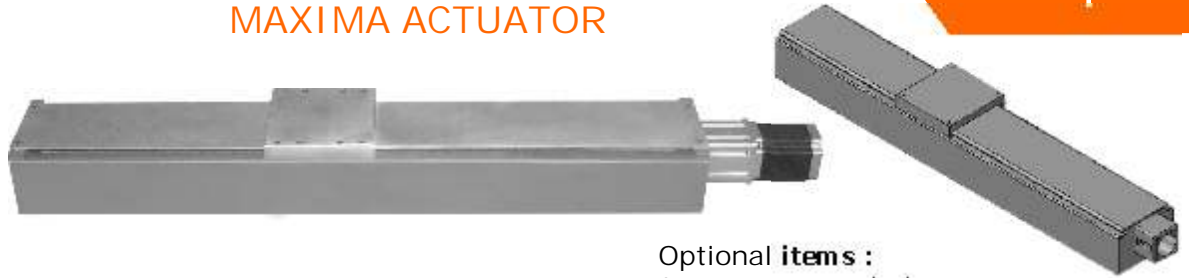

Features

- Metal Cover for dust protection
- Light Weight
- Base plate is aluminium with slots so that actuator can be mounted with nut at any distance
- Motor Mounting Blocks are customizable

Optional items :

- Stepper motor with driver
- Servo Motor with driver
- Controller
- SMPS Power Supply
- Sensor

MAX 180 CH Actuator includes:

- Linear Guides of 20 mm (4 Carriage + 2 rails)
- Ball Screw of 20 mm Dia with pitch option of 5 mm or 20 mm
- Standard Ball Screw Support Units
- Oldham coupling OD 32 mm
- Motor Mounting Block (option of frame size 57,60,86)

Stroke in MM
200 mm
300 mm
400 mm
500 mm
600 mm
700 mm
800 mm
900 mm
1000 mm
1200 mm
1500 mm

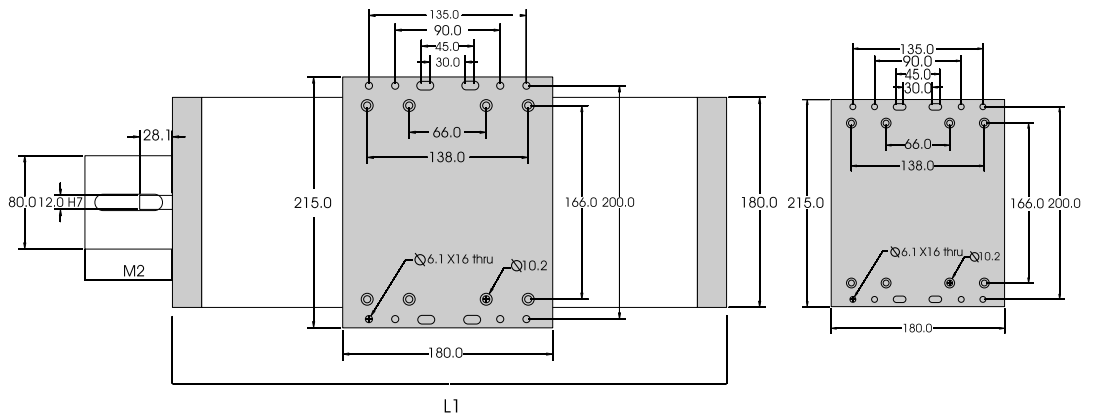
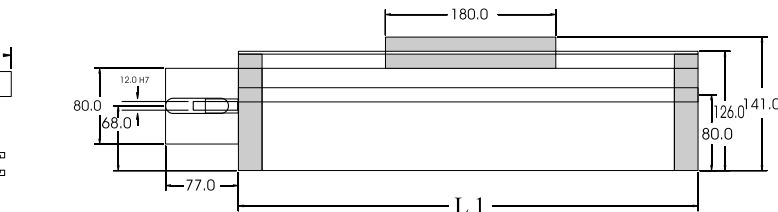
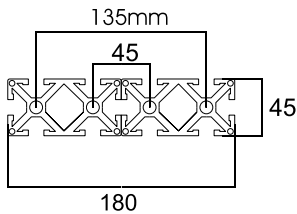
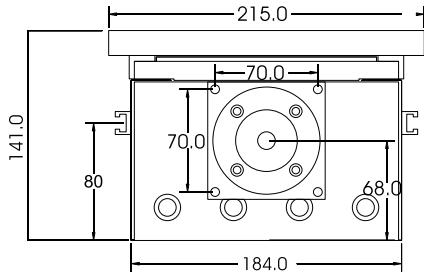

Applications :

- Automation
- Pick and Place
- Engraving
- Liquid Dispensing
- Material Handling

How to Order

MAX 180 C H A- (Stroke) MM

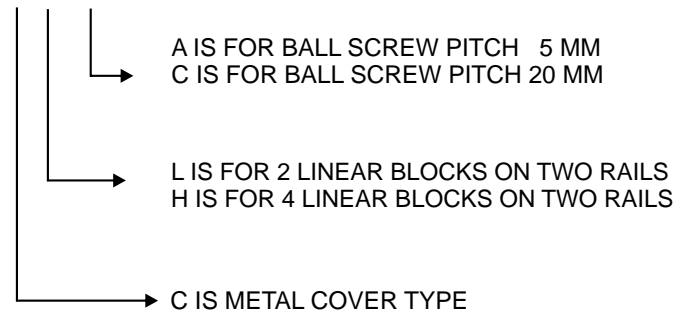

SOLUTIONS FOR INDUSTRIAL AUTOMATION

- Linear Guides
- Ball Screw & Lead Screw
- Ball Screw Support Unit
- Coupling
- Linear Motion Bearing
- Shafts (Hardened & Ground)
- Pillow Block Bearing Unit
- Precision Lock Nut & Power Lock
- Timing Belt & Pulley
- Actuators, X-Y Tables
- Maxima Work Table & Conveyor
- Stepper Motors, Drivers
- AC Servo Motors & Drive
- Motion & Controllers
- Rotary Indexing Tables
- Cable Drag Chain (Robochain)
- Aluminium Profile & Accessories
- Leveling Foot Mount & Autocaster

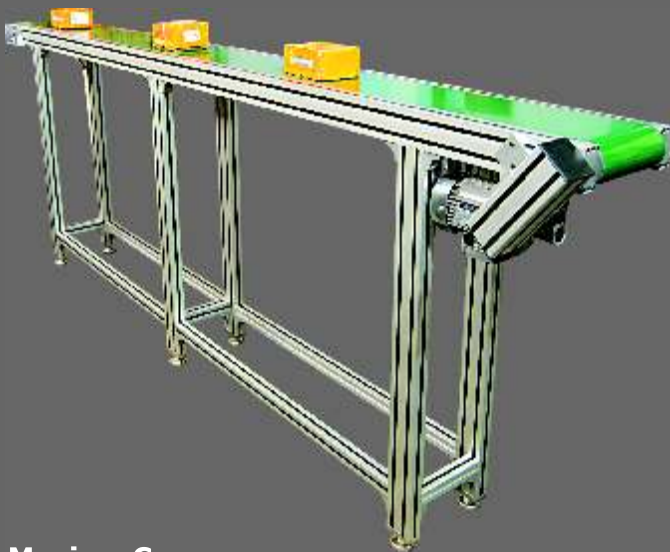

Maxima Conveyor



Maxima Work Table